



LODESTAR®

C A T A L O G 2 0 1 0





Columbus McKinnon Entertainment Technology (CM-ET), the industry leader in providing quality lifting and positioning equipment for riggers around the globe, presents the new Lodestar Electric Chain Hoist. Generations of users have relied on the Lodestar "Motor" for consistent operation and long-life for years, and now exciting new features have been added to widen the appeal of the Lodestar to the next generation of rigging professionals.

In addition to a product line recognized in venues throughout the world, CM-ET has established a network of distributors that provide the highest level of customer service to users in the industry. Wherever the show takes place, a knowledgeable CM-ET distributor is available to offer assistance with parts, service, or accessories.

When searching for products or services to ensure that your event shines, turn to the company with more than 130 years of experience in meeting the needs of our customers – Columbus McKinnon.



THE POWER
TO PERFORM



The Rigger's Choice

We've received the best reviews, heard "Bravo" countless times and, like all the greats, we're recognized in every venue around the world.

So how do we make the legendary Lodestar electric chain hoist even better? By incorporating new features that provide steady operation for any application in the entertainment industry.

From today's top-selling musical performers to international sporting competitions, organizers rely on the Lodestar for consistent performance event after event. Professional riggers have trusted the Lodestar for unsurpassed reliability for decades, and now you can experience the quietest, smoothest-running Lodestar ever. What an Encore!

Specs

CAPACITIES
125 to 3000 kg

LIFT
18, 20 & 24
meters standard
(other lifts available)

SPEEDS
2 to 30 m/min

VOLTAGES
1-phase
& 3-phase available



NEW FEATURES ON THIS NEXT GENERATION OF LODESTAR

5 POCKET LIFTWHEEL
IMPROVED CHAIN WEAR & SMOOTH LIFTING

CLUTCH OUTSIDE GEAR TRAIN
MEETS INTERNATIONAL STANDARDS.

PRECISION HELICAL GEARING
FOR QUIETER OPERATION

REDESIGNED CONTROL PANEL
FOR EASIER ACCESS & FUSE INSTALLATION

STANDARD FEATURES

AC ELECTRO-MECHANICAL BRAKE
Field tested and proven in over 1 million Lodestars worldwide

LOW VOLTAGE CONTROL
110 Volt for long cable runs without voltage drop 24 & 48 Volt optional. (Low Voltage Unit Only)

DURABLE & LIGHTWEIGHT HOUSING
Cast aluminum. Black powder coated finish for low visibility.

GEARING
Helical design for long wear life and smooth operation

LOAD CHAIN
Designed and manufactured by Columbus McKinnon. Zinc plated to protect against corrosion. Optional black finish available.

DUTY CYCLE
FEM Rating: 2m, designed for heavy duty application. 50% of Duty Cycle or 300 Starts per Hour.

DIRECT CONTROL UNITS AVAILABLE

ELECTRICAL
Finger safe wiring meets all electrical codes. Quick change plugs allow for voltages 190 thru 400. Prevents improper voltage connections which can cause hoist damage. (Low Voltage Unit Only)

ADJUSTABLE LIMIT SWITCH
Adjustable screw limit switch that will automatically stop the hook at any predetermined point when either lifting or lowering, preventing overtravel. (Low Voltage Unit Only)

OVERLOAD PROTECTOR
Designed to prevent lifting of excessive overloads. Helps prevent lifting of dangerous overloads.

METRIC RATED

MEETS REQUIREMENTS
Meets or exceeds world standards.

ROAD READY
Easy to stow and travel.

LIFETIME WARRANTY
The industry's best

OPTIONAL FEATURES

DOUBLE BRAKE
Two independent acting DC brakes for redundant braking. Field installation kit available.

ENCODERS AVAILABLE
Incremental & Absolute

CHAIN BAGS
Cloth type bags easy-to-mount

VARIABLE SPEED UNITS AVAILABLE

ALLOY LATCHLOK HOOKS
Remains locked until released by the operator, even if chain goes slack.

LODESTAR D8 SERIES

Specifications, Dimensions & Key Components



LOAD CHAIN

Sizes available from 6.35mm to 7.94mm
Chain is available according to EN 818-7
Meets or exceeds many national and international standards.
Zinc plated supplied as standard. Black phosphate finish available.
100% proof tested

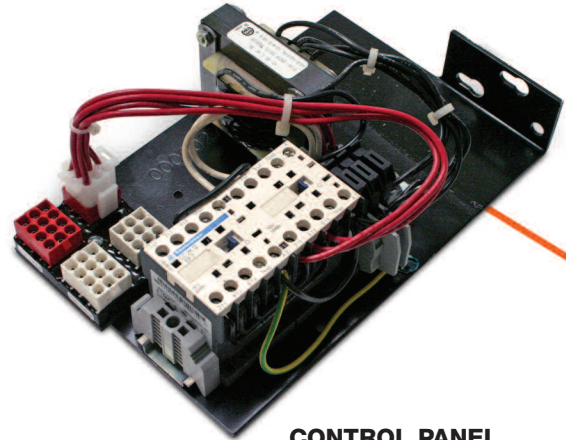

CONTROL PANEL

Provides easy access to controls, plug & play connectors allow for quick voltage change for dual voltage motors. Fuses located on terminal strip.

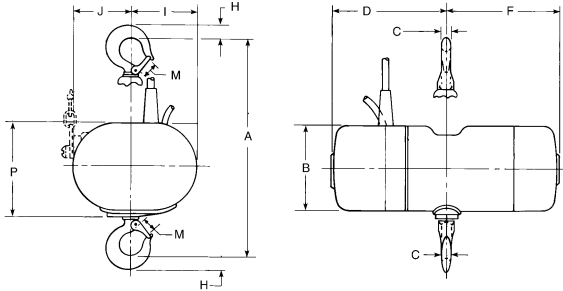

DIMENSIONS

DRAWING LEGEND	D8 SERIES A, AA, B, C, E, F, H	D8+ SERIES A, AA, B, C, E, F, H	D8 & D8+ SERIES J, L, LL	D8 & D8+ SERIES JJ, R, RR, RT	BGV-C1 SERIES		
					F	L, LL	JJ, RR VARISTAR
B Body High	15,4 cm	15,4 cm	19,4 cm	19,4 cm	15,4 cm	19,4 cm	19,4 cm
C Hook Thickness: Side	1,7 cm	1,7 cm	2,2 cm	2,9 cm	1,7 cm	2,2 cm	2,9 cm
D Housing: Brake Side	29,7 cm	29,7 cm	25,3 cm	25,3 cm	29,7 cm	25,3 cm	25,3 cm
F Housing: Motor Side	22,5 cm	22,5 cm	32,9 cm	32,9 cm	22,5 cm	32,9 cm	32,9 cm
H Hook Thickness: High	2,5 cm	2,5 cm	3,0 cm	3,8 cm	2,5 cm	3,0 cm	3,8 cm
I Housing: Side Right	10,7 cm	10,7 cm	14,5 cm	17,9 cm	10,7 cm	14,5 cm	17,9 cm
J Housing: Side Left	11,3 cm	11,3 cm	17,6 cm	14,2 cm	11,3 cm	17,6 cm	14,2 cm
M Hook Opening	2,5 cm	2,5 cm	2,8 cm	3,3 cm	2,5 cm	2,8 cm	3,3 cm
P Body High with Suspension	16,8 cm	16,8 cm	20,8 cm	20,8 cm	16,8 cm	20,8 cm	20,8 cm

SPECIFICATIONS D8

	Rate Capacity	Standard Lifting Speed at 50Hz	Operating Voltage	Single Phase Voltage	FEM Class	FEM Duty Factor	Chain Weight per meter lift-EWL	Load Chain EN 818-7	Power Consumption -Full Load	Reeves Falls of Chain	Motor HP	Protection Class	Noise Level
Model A	125 kg	8 m/min	400-3-50	optional	2M	50%	0,89 kg	6,3 x 18,9	1,1 A	1	1/4 HP	IP 55	73 db(A)
Model AA	125 kg	16 m/min	400-3-50	optional	2M	50%	0,89 kg	6,3 x 18,9	1,1 A	1	1/4 HP	IP 55	73 db(A)
Model B	250 kg	4 m/min	400-3-50	optional	2M	50%	0,89 kg	6,3 x 18,9	1,1 A	1	1/4 HP	IP 55	73 db(A)
Model C	250 kg	8 m/min	400-3-50	optional	2M	50%	0,89 kg	6,3 x 18,9	1,2 A	1	1/2 HP	IP 55	73 db(A)
Model E	500 kg	2 m/min	400-3-50	optional	2M	50%	1,78 kg	6,3 x 18,9	1,2 A	2	1/2 HP	IP 55	73 db(A)
Model F	500 kg	4 m/min	400-3-50	optional	2M	50%	0,89 kg	6,3 x 18,9	1,2 A	1	1/2 HP	IP 55	73 db(A)
Model H	1000 kg	2 m/min	400-3-50	optional	2M	50%	1,78 kg	6,3 x 18,9	1,2 A	2	1/2 HP	IP 55	73 db(A)
Model J	500 kg	8 m/min	400-3-50	-	2M	50%	1,42 kg	7,9 x 21,7	2,3 A	1	1 HP	IP 55	73 db(A)
Model JJ	500 kg	16 m/min	400-3-50	-	2M	50%	1,42 kg	7,9 x 21,7	3,6 A	1	2 HP	IP 55	73 db(A)
Model L	1000 kg	4 m/min	400-3-50	optional	2M	50%	1,42 kg	7,9 x 21,7	2,3 A	1	1 HP	IP 55	73 db(A)
Model LL	1000 kg	8 m/min	400-3-50	-	2M	50%	1,42 kg	7,9 x 21,7	3,6 A	1	2 HP	IP 55	73 db(A)
Model R	2000 kg	2 m/min	400-3-50	optional	2M	50%	2,84 kg	7,9 x 21,7	2,3 A	2	1 HP	IP 55	73 db(A)
Model RR	2000 kg	4 m/min	400-3-50	-	2M	50%	2,84 kg	7,9 x 21,7	3,6 A	2	2 HP	IP 55	73 db(A)
Model RT	3000 kg	1,4 m/min	400-3-50	optional	2M	50%	4,26 kg	7,9 x 21,7	3,6 A	3	2 HP	IP 55	73 db(A)

*415 Volt Operation

*220 Volt Operation



LIFT WHEEL

5 Pocket Liftwheel increases chain and liftwheel engagement while providing smoother lifting, less vibration and reduced chain wear when properly maintained.

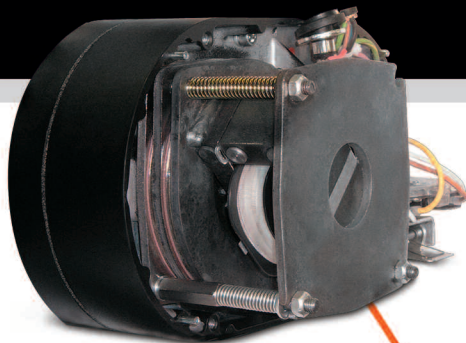

BRAKE

Heavy Duty AC Brake proven design in more than 1 million Lodestars. (Double DC Brake available)

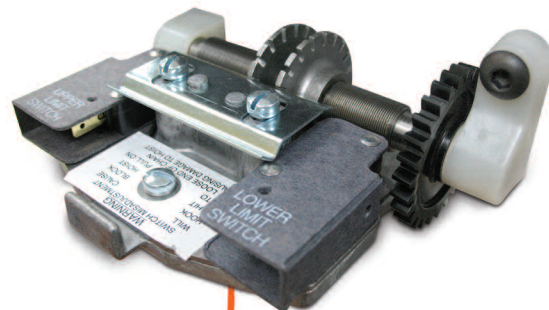

LIMIT SWITCH

Adjustable screw limit switch that will automatically stop the hook at any predetermined point when either hoisting or lifting.

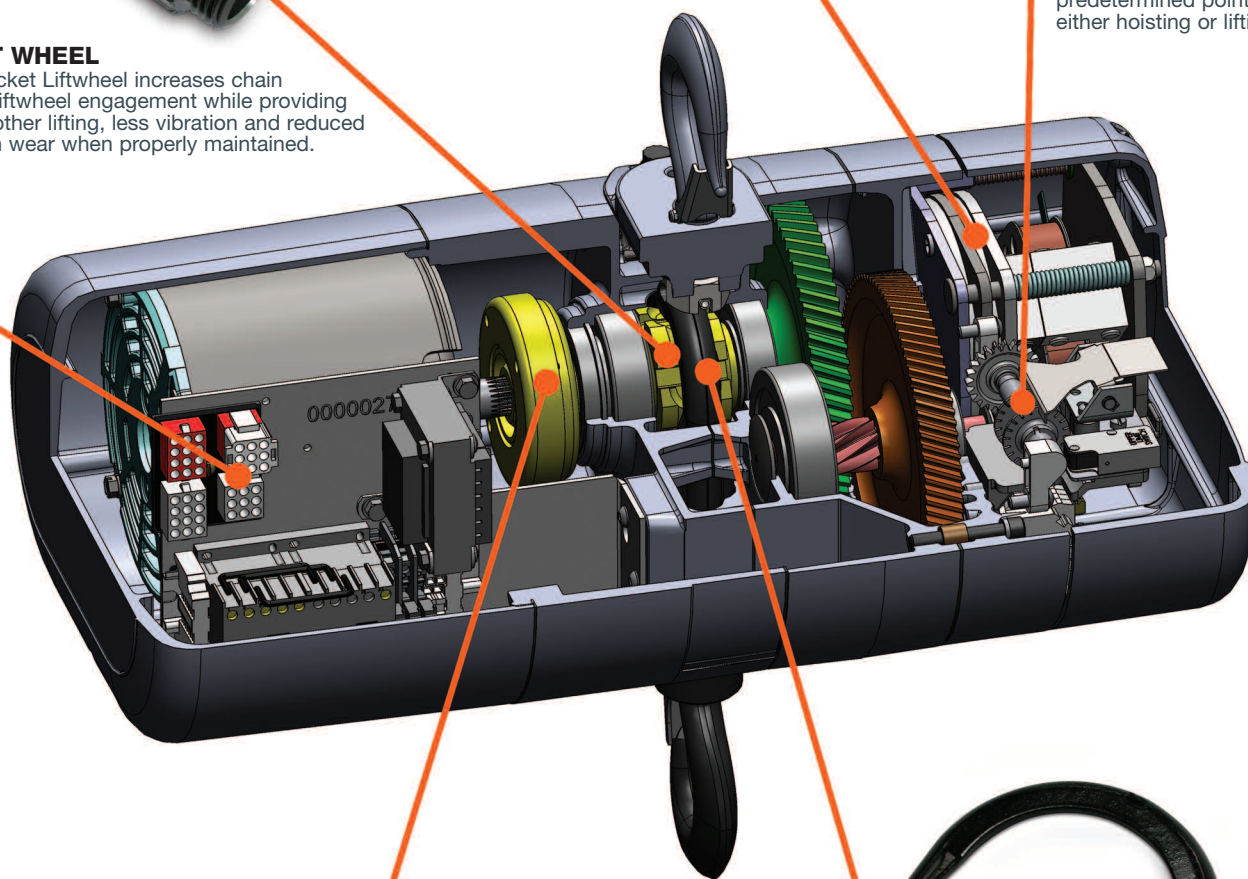

CLUTCH

Designed to prevent lifting of excessive overloads. Located outside the gear box. Adjustable and easy to access.

INTERNAL CHAIN GUIDE

Stamped Steel guide coated for corrosion resistance and quiet operation, while keeping the load chain and liftwheel aligned.

