

SIRIUS HRI 440 W

SIRIUS HRI brand | High-pressure discharge lamps with reflector



Areas of application

- Concert lighting
- Club and disco
- Stage and theatre
- Studio, TV and film
- Architecture & Architainment

Product family benefits

- Lightweight and compact reflector lamps
- Perfectly suited for small and lightweight moving heads
- Optimized burner design allows any burning position
- High luminance through very short arc and high pressure
- Bright light for brilliant light effects
- Long lifetime
- Easy lamp replacement
- Stable light output over the entire lifetime



Technical data

Electrical data

Nominal wattage	440.00 W
Nominal current	5.3 A
Ignition voltage	2.5 kVp
Nominal voltage	83.0 V

Photometrical data

Nominal luminous flux	20000 lm
Color temperature	7000 K
Color rendering index Ra	80
Maximum color temperature	7000 K

Light technical data

Focal length	41.0 mm
Aperture window, maximum	8.0 mm

Dimensions & weight

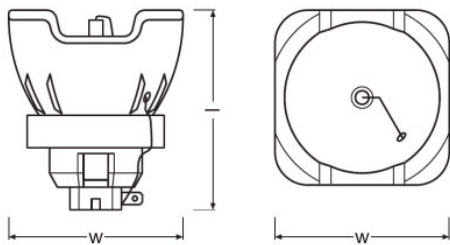

Diameter	58.0 mm
Length	71.0 mm
Arc length	1.3 mm

Lifespan

Lifespan	1500 h
----------	--------

Capabilities

Burning position	Any
Cooling	Forced

Certificates & standards

EEI – Energy Label	A
--------------------	---

Environmental information

Information according Art. 33 of EU Regulation (EC) 1907/2006 (REACH)	
Date of Declaration	07-04-2022
Primary Article Identifier	4052899222212 4052899259096 4052899553644 4052899570566 4052899587892
Candidate List Substance 1	No declarable substances contained
Declaration No. in SCIP database	In work

Product datasheet

Safety advice

Because of their high luminance, UV radiation and high internal pressure during operation, SIRIUS HRI lamps may only be operated in enclosed lamp casings specially constructed for the purpose. Appropriate filters must ensure that UV radiation is reduced to an acceptable level. Mercury is released if the lamp breaks. Special safety precautions must be taken. Information on safety and handling is available on request or can be found in the leaflet included with the lamp or in the operating instructions.

Logistical Data

Product code	Product description	Packaging unit (Pieces/Unit)	Dimensions (length x width x height)	Volume	Gross weight
4052899222212	SIRIUS HRI 440 W	Unpacked 1	600 mm x 400 mm x 163 mm	39.12 dm ³	8902.00 g
4052899222229	SIRIUS HRI 440 W	Shipping carton box 60	414 mm x 329 mm x 348 mm	47.40 dm ³	7504.00 g
4052899259096	SIRIUS HRI 440 W	Folding carton box 1	87 mm x 87 mm x 103 mm	0.78 dm ³	148.00 g
4052899259102	SIRIUS HRI 440 W	Shipping carton box 2	186 mm x 96 mm x 115 mm	2.05 dm ³	342.00 g
4052899259119	SIRIUS HRI 440 W	Shipping carton box 20	507 mm x 203 mm x 264 mm	27.17 dm ³	3901.00 g

The mentioned product code describes the smallest quantity unit which can be ordered. One shipping unit can contain one or more single products. When placing an order, for the quantity please enter single or multiples of a shipping unit.

Disclaimer

Subject to change without notice. Errors and omission excepted. Always make sure to use the most recent release.